

# HOW TO MEASURE YOUR KITCHEN OR BATH FOR NEW CABINETS

Accurate measurements of your kitchen or bath are essential when designing your new cabinet layout. Please follow the steps in this kitchen and bath planner, and a 411 Kitchen Cabinets product specialist will guide you toward the best cabinet solution for your space.

## Floor Plan

You will need to carefully configure the exact dimensions of your room. Your completed floor plan should resemble the diagram below. Be sure to show exact locations of doors, windows, hood vents, exhaust, gas lines, water lines, drain lines, outlets, switches, light fixtures, and heat vents.

First, you'll need a detailed floor plan to determine an ideal cabinet configuration for your remodel. Your completed floor plan should resemble the diagram below:

### NOTE: ALWAYS DOUBLE CHECK MEASUREMENTS

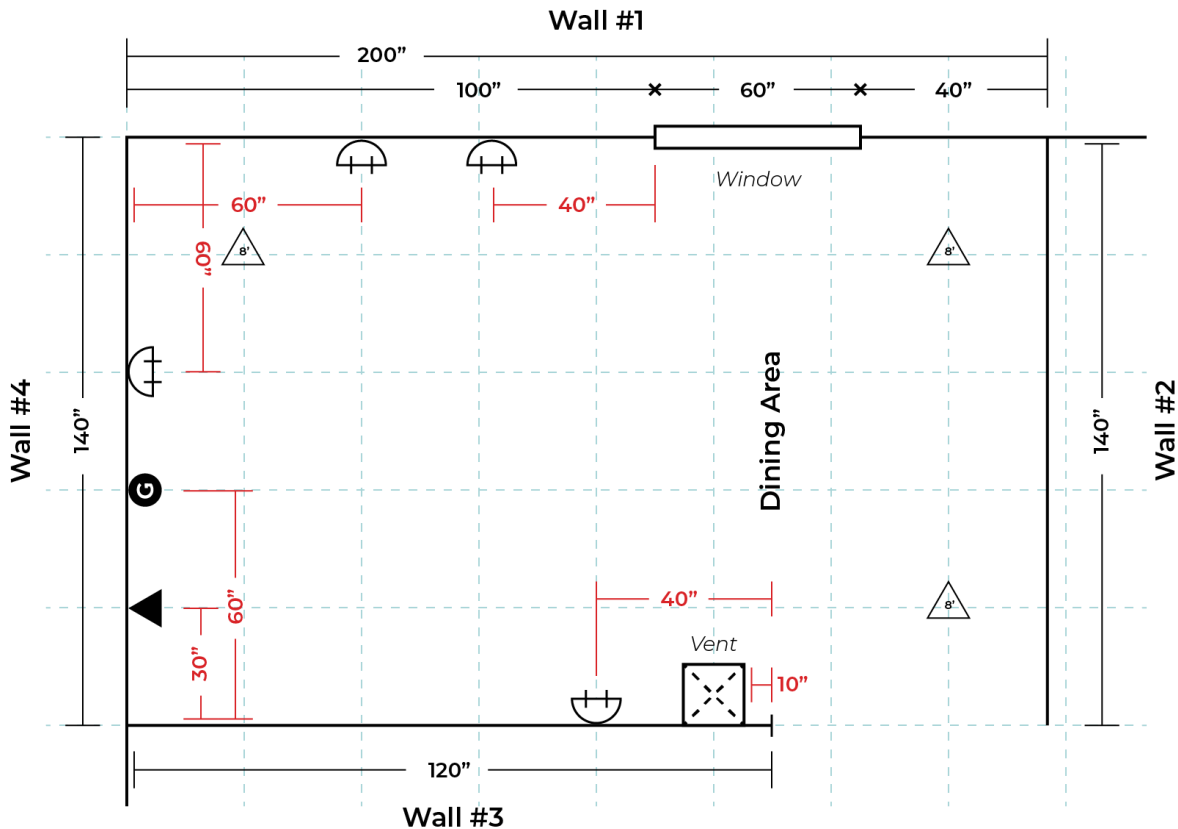

# HOW TO MEASURE YOUR KITCHEN OR BATH FOR NEW CABINETS

## Step 1. Record Your Horizontal Measurements

Using a tape measure and graph paper, measure your room using the following steps:

1. Measure from **wall to wall at 36" height**.
2. Measure from **corner to window or door opening**.
3. Measure across **opening from trim edge to trim edge**.
4. Measure from **edge of trim to far wall**—compare to sum of #2, #3, and #4.
5. Measure from **wall to wall above window** and compare to #1.

## Step 2. Record Your Vertical Measurements

6. Measure from **floor to window sill**.
7. Measure from **window sill to top of window**.
8. Measure from **top of window to ceiling**.
9. Measure from **floor to ceiling**—compare to sum of #7, #8, and #9.

## Step 3. Draw Your Floor Plan

You will need to carefully configure the exact dimensions of your room. Be sure to show the exact locations of:

- |                                     |                                      |   |
|-------------------------------------|--------------------------------------|---|
| <input type="checkbox"/> Doors      | <input type="checkbox"/> Gas lines   | <input type="checkbox"/> Switches       |
| <input type="checkbox"/> Windows    | <input type="checkbox"/> Water lines | <input type="checkbox"/> Light fixtures |
| <input type="checkbox"/> Hood vents | <input type="checkbox"/> Drain lines | <input type="checkbox"/> Heat vents     |
| <input type="checkbox"/> Exhaust    | <input type="checkbox"/> Outlets     |   |

Each large square represents 1 square ft. Each small square represents 3".

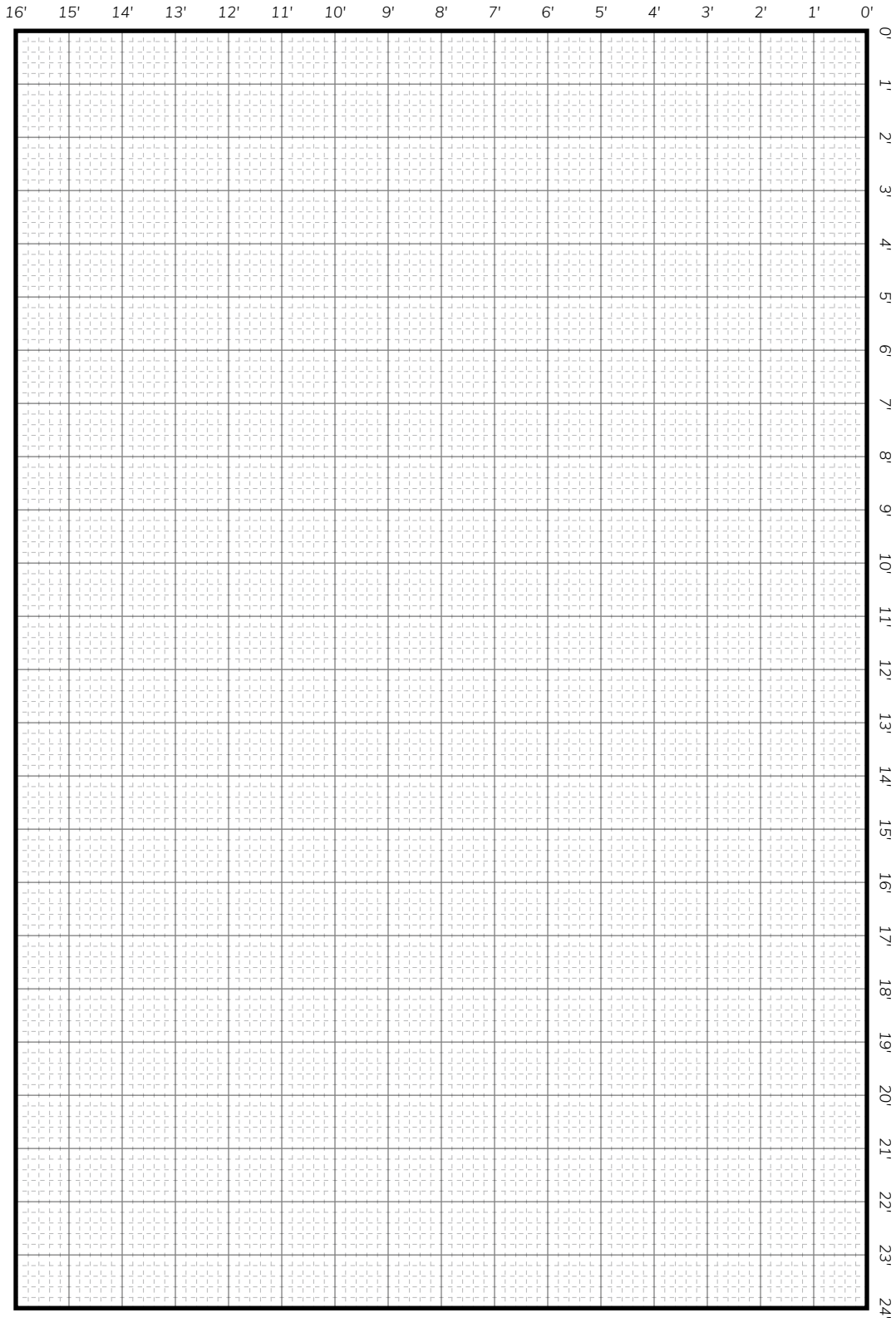

Use this key to label openings and obstructions on your kitchen floor plan.

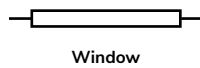

Window



Obstruction



Water Line



Gas Line



Outlet

## APPLIANCE AND FIXTURE INFORMATION

List desired or existing appliances included on your floor plan. Be sure to indicate 220 volt outlets, wall-mounted appliances and fixtures, telephone, and cable locations. Also, note gas lines and appliance locations.

	Type	Size W x D x H	Hinge Position L/R <small>(Facing Appliance)</small>
Refrigerator			
Range			
Cooktop			
Exhaust Hood			
Wall Oven			
Microwave			
Dishwasher			
Sink			
Disposal			
Compactor			
Freezer			
Other			